

Technical alternative not acceptable.

Purchase order can be split upon award. AFPC encourages bidders to submit a whole order discount, which shall be applied in case of awarding all items without split.

DESCRIPTION OF GOODS AND / OR SERVICES.

Item	Cmdty	MESC	Qty	UoM	Description
					P/F VACUUM PUMPS: NASH KOREA LTD MODEL AT3004 DRG.NO.15-0436, S/N.9600691-1 D E S C R I P T I O N
tem 1	22XXXX	23.68.30.202.3	4	UNITS	PACKING(SET) ITEM NO 1
					P/F VACUUM PUMPS: NASH KOREA LTD MODEL AT3004 DRG.NO.15-0436, S/N.9600691-1 D E S C R I P T I O N
tem 2	22XXXX	23.68.30.204.3	2	UNITS	PACKING(SET) ITEM NO 1-1
					P/F VACUUM PUMPS: NASH KOREA LTD MODEL AT3004 DRG.NO.15-0436, S/N.9600691-1 D E S C R I P T I O N
tem 3	22XXXX	23.68.30.206.3	4	UNITS	SLINGER ITEM NO 3
					P/F VACUUM PUMPS: NASH KOREA LTD MODEL AT3004 DRG.NO.15-0436, S/N.9600691-1 D E S C R I P T I O N
tem 4	22XXXX	23.68.30.208.3	4	UNITS	SLINGER SPRING ITEM NO 3-1
					P/F VACUUM PUMPS: NASH KOREA LTD MODEL AT3004 DRG.NO.15-0436, S/N.9600691-1 D E S C R I P T I O N
tem 5	22XXXX	23.68.30.210.3	2	UNITS	SLINGER ITEM NO 3-2
					P/F VACUUM PUMPS: NASH KOREA LTD MODEL AT3004 DRG.NO.15-0436, S/N.9600691-1 D E S C R I P T I O N
tem 6	22XXXX	23.68.30.212.3	2	UNITS	SLINGER SPRING ITEM NO 3-4
					P/F VACUUM PUMPS: NASH KOREA LTD MODEL AT3004 DRG.NO.15-0436, S/N.9600691-1 D E S C R I P T I O N
tem 7	22XXXX	23.68.30.214.3	2	UNITS	SHIM(SET) ITEM NO 4
					P/F VACUUM PUMPS: NASH KOREA LTD MODEL AT3004 DRG.NO.15-0436, S/N.9600691-1 D E S C R I P T I O N
tem 8	22XXXX	23.68.30.216.3	8	UNITS	SHIM(SET) ITEM NO 4-1
					P/F VACUUM PUMPS: NASH KOREA LTD MODEL AT3004 DRG.NO.15-0436, S/N.9600691-1 D E S C R I P T I O N
tem 9	22XXXX	23.68.30.218.3	2	UNITS	SHIM ITEM NO 4-2
					P/F VACUUM PUMPS: NASH KOREA LTD MODEL AT3004 DRG.NO.15-0436, S/N.9600691-1 D E S C R I P T I O N
tem 10	22XXXX	23.68.30.220.3	2	UNITS	SHIM(SET) ITEM NO 4-3
					P/F VACUUM PUMPS: NASH KOREA LTD MODEL AT3004 DRG.NO.15-0436, S/N.9600691-1 D E S C R I P T I O N
tem 11	22XXXX	23.68.30.222.3	4	UNITS	LIP SEAL ITEM NO 5
					P/F VACUUM PUMPS: NASH KOREA LTD MODEL AT3004 DRG.NO.15-0436, S/N.9600691-1 D E S C R I P T I O N

				P/F VACUUM PUMPS: NASH KOREA LTD MODEL AT3004	
				DRG.NO.15-0436, S/N.9600691-1	
				D E S C R I P T I O N	ITEM NO
tem 13	22XXXX	23.68.30.225.3	4 UNITS	LANTERN GLAND	10
				P/F VACUUM PUMPS: NASH KOREA LTD MODEL AT3004	
				DRG.NO.15-0436, S/N.9600691-1	
				D E S C R I P T I O N	ITEM NO
tem 14	22XXXX	23.68.30.228.3	4 UNITS	FIRST STAGE BODY GASKET(SET)	101-3
				P/F VACUUM PUMPS: NASH KOREA LTD MODEL AT3004	
				DRG.NO.15-0436, S/N.9600691-1	
				D E S C R I P T I O N	ITEM NO
tem 15	22XXXX	23.68.30.230.3	6 UNITS	IE HEAD STUD GASKET	103-3
				P/F VACUUM PUMPS: NASH KOREA LTD MODEL AT3004	
				DRG.NO.15-0436, S/N.9600691-1	
				D E S C R I P T I O N	ITEM NO
tem 16	22XXXX	23.68.30.232.3	2 UNITS	DE CONE GASKET	104-3
				P/F VACUUM PUMPS: NASH KOREA LTD MODEL AT3004	
				DRG.NO.15-0436, S/N.9600691-1	
				D E S C R I P T I O N	ITEM NO
tem 17	22XXXX	23.68.30.234.3	2 UNITS	IE CONE GASKET	105-3
				P/F VACUUM PUMPS: NASH KOREA LTD MODEL AT3004	
				DRG.NO.15-0436, S/N.9600691-1	
				D E S C R I P T I O N	ITEM NO
tem 18	22XXXX	23.68.30.236.3	1 UNITS	FIRST STAGE ROTOR(1100-499)	110
				P/F VACUUM PUMPS: NASH KOREA LTD MODEL AT3004	
				DRG.NO.15-0436, S/N.9600691-1	
				D E S C R I P T I O N	ITEM NO
tem 19	22XXXX	23.68.30.238.3	1 UNITS	SHAFT(425-196)	111
				P/F VACUUM PUMPS: NASH KOREA LTD MODEL AT3004	
				DRG.NO.15-0436, S/N.9600691-1	
				D E S C R I P T I O N	ITEM NO
tem 20	22XXXX	23.68.30.240.3	2 UNITS	OUTER DE BEARING CAP GASKET	115-3
				P/F VACUUM PUMPS: NASH KOREA LTD MODEL AT3004	
				DRG.NO.15-0436, S/N.9600691-1	
				D E S C R I P T I O N	ITEM NO
tem 21	22XXXX	23.68.30.242.3	2 UNITS	INNER DE BEARING CAP GASKET	116-3
				P/F VACUUM PUMPS: NASH KOREA LTD MODEL AT3004	
				DRG.NO.15-0436, S/N.9600691-1	
				D E S C R I P T I O N	ITEM NO
tem 22	22XXXX	23.68.30.244.3	2 UNITS	O-RING	119-1

				P/F VACUUM PUMPS: NASH KOREA LTD MODEL AT3004	
				DRG.NO.15-0436, S/N.9600691-1	
				D E S C R I P T I O N	ITEM NO
Item 23	22XXXX	23.68.30.246.3	2 UNITS	DE BEARING(15-7)	119
				P/F VACUUM PUMPS: NASH KOREA LTD MODEL AT3004	
				DRG.NO.15-0436, S/N.9600691-1	
				D E S C R I P T I O N	ITEM NO
Item 24	22XXXX	23.68.30.248.3	2 UNITS	DE BEARING LOCKNUT	119-1
				P/F VACUUM PUMPS: NASH KOREA LTD MODEL AT3004	
				DRG.NO.15-0436, S/N.9600691-1	
				D E S C R I P T I O N	ITEM NO
Item 25	22XXXX	23.68.30.250.3	2 UNITS	DE BEARING LOCKWASHER	119-2
				P/F VACUUM PUMPS: NASH KOREA LTD MODEL AT3004	
				DRG.NO.15-0436, S/N.9600691-1	
				D E S C R I P T I O N	ITEM NO
Item 26	22XXXX	23.68.30.252.3	2 UNITS	IE BEARING (15-7)	120
				P/F VACUUM PUMPS: NASH KOREA LTD MODEL AT3004	
				DRG.NO.15-0436, S/N.9600691-1	
				D E S C R I P T I O N	ITEM NO
Item 27	22XXXX	23.68.30.254.3	2 UNITS	IE BEARING LOCKNUT	120-1
				P/F VACUUM PUMPS: NASH KOREA LTD MODEL AT3004	
				DRG.NO.15-0436, S/N.9600691-1	
				D E S C R I P T I O N	ITEM NO
Item 28	22XXXX	23.68.30.256.3	2 UNITS	IE BEARING LOCKWASHER	120-2
				P/F VACUUM PUMPS: NASH KOREA LTD MODEL AT3004	
				DRG.NO.15-0436, S/N.9600691-1	
				D E S C R I P T I O N	ITEM NO
Item 29	22XXXX	23.68.30.258.3	1 UNITS	INTERSTAGE CHECK VALVE ASSY	529
				P/F VACUUM PUMPS: NASH KOREA LTD MODEL AT3004	
				DRG.NO.15-0436, S/N.9600691-1	
				D E S C R I P T I O N	ITEM NO
Item 30	22XXXX	23.68.30.260.3	2 UNITS	CHECK VALVE GASKET	529-3
				P/F VACUUM PUMPS: NASH KOREA LTD MODEL AT3004	
				DRG.NO.15-0436, S/N.9600691-1	
				D E S C R I P T I O N	ITEM NO
Item 31	22XXXX	23.68.30.262.3	2 UNITS	SECOND STAGE LOBE GASKET	601-3
				P/F VACUUM PUMPS: NASH KOREA LTD MODEL AT3004	
				DRG.NO.15-0436, S/N.9600691-1	
				D E S C R I P T I O N	ITEM NO

				P/F VACUUM PUMPS: NASH KOREA LTD MODEL AT3004	
				DRG.NO.15-0436, S/N.9600691-1	
				D E S C R I P T I O N	ITEM NO
Item 33	22XXXX	23.68.30.266.3	1	UNITS SECOND STAGE ROTOR (480-218)	610
				P/F VACUUM PUMPS: NASH KOREA LTD MODEL AT3004	
				DRG.NO.15-0436, S/N.9600691-1	
				D E S C R I P T I O N	ITEM NO
Item 34	22XXXX	23.68.30.268.3	2	UNITS SECOND STAGE ROTOR LOCKNUT	610-1
				P/F VACUUM PUMPS: NASH KOREA LTD MODEL AT3004	
				DRG.NO.15-0436, S/N.9600691-1	
				D E S C R I P T I O N	ITEM NO
Item 35	22XXXX	23.68.30.270.3	2	UNITS SECOND STAGE ROTOR WASHER	610-2
				P/F VACUUM PUMPS: NASH KOREA LTD MODEL AT3004	
				DRG.NO.15-0436, S/N.9600691-1	
				D E S C R I P T I O N	ITEM NO
Item 36	22XXXX	23.68.30.272.3	1	UNITS SHAFT ROTOR KEY	610-4
				P/F VACUUM PUMPS: NASH KOREA LTD MODEL AT3004	
				DRG.NO.15-0436, S/N.9600691-1	
				D E S C R I P T I O N	ITEM NO
Item 37	22XXXX	23.68.30.274.3	2	UNITS SECOND STAGE MANIFOLD GASKET	634-3
				P/F VACUUM PUMPS: NASH KOREA LTD MODEL AT3004	
				DRG.NO.15-0436, S/N.9600691-1	
				D E S C R I P T I O N	ITEM NO
Item 38	22XXXX	23.68.30.276.3	2	UNITS SECOND STAGE MANIFOLD COVER GASKET	639-3
				P/F VACUUM PUMPS: NASH-KINEMA MODEL AT3004	
				DRG.NO.D-802239	
				BULLETIN NO. 635 SERIES 467-03004	
				D E S C R I P T I O N	ITEM NO
Item 39	22XXXX	23.68.30.101.3	4	UNITS REPAIR KIT	
				Part NO. X1S-043688-1003	NASH-KINEMA
				P/F VACUUM PUMPS: NASH-KINEMA MODEL AT3004	
				DRG.NO.D-802239	
				BULLETIN NO. 635 SERIES 467-03004	
				D E S C R I P T I O N	ITEM NO
Item 40	22XXXX	23.68.30.103.3	4	UNITS MOTIVE NOZZLE, SS316	
				Part NO. AN-107481	NASH-KINEMA
				P/F VACUUM PUMPS: NASH-KINEMA MODEL AT3004	
				DRG.NO.D-802239	

Item 40	22XXXX	23.68.30.103.3	4 UNITS	<p>DESCRIPTION</p> <p>MOTIVE NOZZLE, SS316</p> <p>Part NO. AN-107481</p> <p>NASH-KINEMA</p> <p>P/F VACUUM PUMPS: NASH-KINEMA MODEL AT3004</p> <p>DRG.NO.D-802239</p> <p>BULLETIN NO. 635 SERIES 467-03004</p>
Item 41	22XXXX	23.68.30.105.3	4 UNITS	<p>DESCRIPTION</p> <p>GASKET, 1/16", SS316</p> <p>Part NO. A-100530-73</p> <p>NASH-KINEMA</p> <p>P/F VACUUM PUMPS: NASH-KINEMA MODEL AT3004</p> <p>DRG.NO.D-802239</p> <p>BULLETIN NO. 635 SERIES 467-03004</p>
Item 42	22XXXX	23.68.30.107.3	4 UNITS	<p>DESCRIPTION</p> <p>GASKET, 1/16", SS316</p> <p>Part NO. A-100530-39</p> <p>NASH-KINEMA</p> <p>P/F VACUUM PUMPS: NASH-KINEMA MODEL AT3004</p> <p>DRG.NO.D-802239</p> <p>BULLETIN NO. 635 SERIES 467-03004</p>
Item 43	22XXXX	23.68.30.109.3	4 UNITS	<p>DESCRIPTION</p> <p>SPACER, 1/8", SS316</p> <p>Part NO. A-100530-43</p> <p>NASH-KINEMA</p> <p>P/F VACUUM PUMPS: NASH-KINEMA MODEL AT3004</p> <p>DRG.NO.D-802239</p> <p>BULLETIN NO. 635 SERIES 467-03004</p>
Item 44	22XXXX	23.68.30.111.3	4 UNITS	<p>DESCRIPTION</p> <p>SPACER, 1/8", SS316</p> <p>Part NO. A-100530-46</p> <p>NASH-KINEMA</p>

Note: Partnumbers shown are the latest ones available in AFPC records. The reason for any change to these to be provided in your quotation.

LEGEND FOR FIGURE 49

(First number in parentheses indicates weight in pounds followed by a dash and weight in kilograms)

Index No.	Part Name	Index No.	Part Name	Index No.	Part Name
1	*Packing	103-6	Stuffing Box Stud	529	Interstage Check Valve Assembly
1-1	*Packing	104	DE Cone (110-50)	529-1	Check Valve Nut
3	*Slinger	104-1	DE Cone Cap Screw	529-3	*Check Valve Gasket
3-1	*Slinger Spring	104-3	*DE Cone Gasket	601	Second Stage Lobe (600-272)
3-2	*Slinger	105	IE Cone (110-50)	601-1	Second Stage Lobe Stud Nut
3-4	*Slinger Spring	105-1	IE Cone Cap Screw	601-2	Second Stage Lobe Stud
4	*Shim	105-3	*IE Cone Gasket	601-3	*Second Stage Lobe Gasket
4-1	*Shim	110	First Stage Rotor (1100-499)	605	Second Stage Cone (173-78)
4-2	*Shim	110-1	Rotor Key (Bronze Rotor Only)	605-3	*Second Stage Cone Gasket
4-3	*Shim	111	Shaft (425-196)	605-5	Second Stage Cone/Head Stud
5	Lip Seal	111-1	Shaft Key	608	Bracket (455-206)
5-1	Lip Seal	112	Gland	608-1	Stuffing Box Stud Nut
6	Oiler (With Sight Glass)	115	Outer DE Bearing Cap	608-2	Bracket Stud
10	Lantern Gland	115-1	Outer DE Bearing Cap Bolt	608-4	Bracket Body Bolt
22-1	Drain Plug	115-2	Outer DE Bearing Cap Nut	610	Second Stage Rotor (480-218)
22-2	Drain Plug	115-3	*Outer DE Bearing Cap Gasket	610-1	*Second Stage Rotor Locknut
22-3	Drain Plug	115-4	Outer DE Bearing Cap Bolt	610-2	*Second Stage Rotor Washer
22-4	Drain Plug	116	Inner DE Bearing Cap	610-4	Shaft Rotor Key
22-5	Drain Plug	116-3	*Inner DE Bearing Cap Gasket	613	Gland
22-6	Drain Plug	117	Outer IE Bearing Cap	634	Second Stage Manifold (385-175)
24	Vent	117-1	Outer IE Bearing Cap Nut	634-1	Second Stage Manifold Nut
101	First Stage Body (1180-535)	117-2	Outer IE Bearing Cap Washer	634-2	Second Stage Manifold Stud
101-1	First Stage Body Stud Nut	117-3	Outer IE Bearing Cap Bolt	634-3	*Second Stage Manifold Gasket
101-2	First Stage Body Stud	117-4	Outer IE Bearing Cap Bolt	639	Second Stage Manifold Cover (195-88)
101-3	*First Stage Body Gasket	117-5	Outer IE Bearing Cap Screw	639-1	Second Stage Manifold Cover Nut
102	DE Head (712-323)	117-6	Outer IE Bearing Cap Washer	639-3	*Second Stage Manifold Cover Gasket
102-1	Stuffing Box Stud Nut	117-7	Outer IE Bearing Cap Screw		
102-2	DE Head Stud	117-8	Outer IE Bearing Cap Washer		
102-3	DE Head Stud Gasket	118	Inner IE Bearing Cap		
102-4	DE Head Stud Nut	118-1	*O Ring		
102-6	Stuffing Box Stud	119	*DE Bearing (15-7)		
103	IE Head (712-323)	119-1	DE Bearing Locknut		
103-1	Stuffing Box Stud Nut	119-2	DE Bearing Lockwasher		
103-2	IE Head Stud	120	*IE Bearing (15-7)		
103-3	IE Head Stud Gasket	120-1	IE Bearing Locknut		
103-4	IE Head Nut	120-2	IE Bearing Lockwasher		

*Minimum recommended spares.

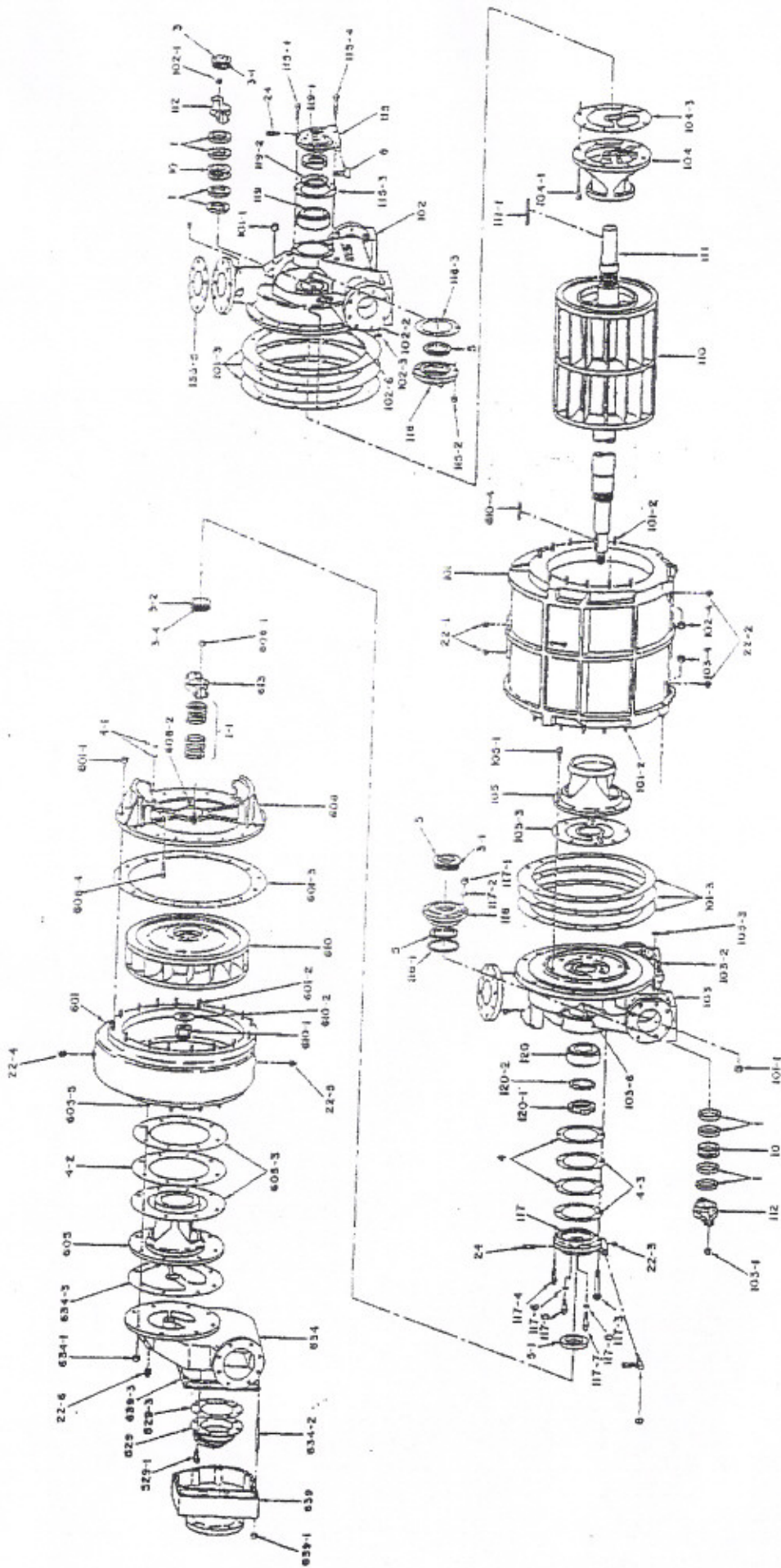

Figure 49. Two Stage Vacuum Pump, Exploded View

Drawing 15-0436